



# Godrej eon<sup>®</sup>

How to get the best out of your Godrej Eon Washing Machine...



User Manual

GWF 650 FH

GWF 650 FC

Fully Automatic Washing Machine





## Contents

<b>Description Of Parts</b>	<b>1</b>
<b>Specifications</b>	<b>2</b>
<b>Know Your Washing Machine</b>	<b>3</b>
<b>How To Install</b>	<b>4</b>
Choosing The Right Location	
Step-by-step Installation	
Ensuring Proper Earthing	
Installing The Drainage Hose	
Collapsible Drainage Hose Extension	
Moving The Drainage Hose	
Attaching The Water Feed Hose To The Tap	
Connecting The Water Feed Hose To Your Washing Machine	
<b>Description: Control Panel</b>	<b>9</b>
<b>Operation Of Functions</b>	<b>11</b>
<b>The Washing Process</b>	<b>14</b>
<b>Program Cycles</b>	<b>15</b>
<b>Type Of Clothes That Can Be Washed</b>	<b>17</b>
<b>In Various Wash Programs</b>	
<b>How To Select Water Level And Load Size</b>	<b>18</b>
<b>How To Measure Wash Load</b>	<b>19</b>
<b>How To Operate</b>	<b>20</b>
When Washing Using The FUZZY Cycle	
When Washing Woolens	
<b>Washing Tips</b>	<b>22</b>
<b>How To Use Bleach</b>	<b>23</b>
<b>Safety Instructions</b>	<b>24</b>
<b>How To Maintain</b>	<b>25</b>
Water Inlet	
Washing Machine Body	
Lint Collector	
<b>When Do You Call The Service Person</b>	<b>26</b>
<b>Don't Worry When...</b>	<b>27</b>
<b>Trouble Shooting</b>	<b>28</b>
<b>Key Checklist</b>	<b>29</b>
<b>Environment Friendly Suggestions</b>	<b>30</b>
<b>Service Centres</b>	<b>31</b>

100

95

75

25

5

0



## Description Of Parts

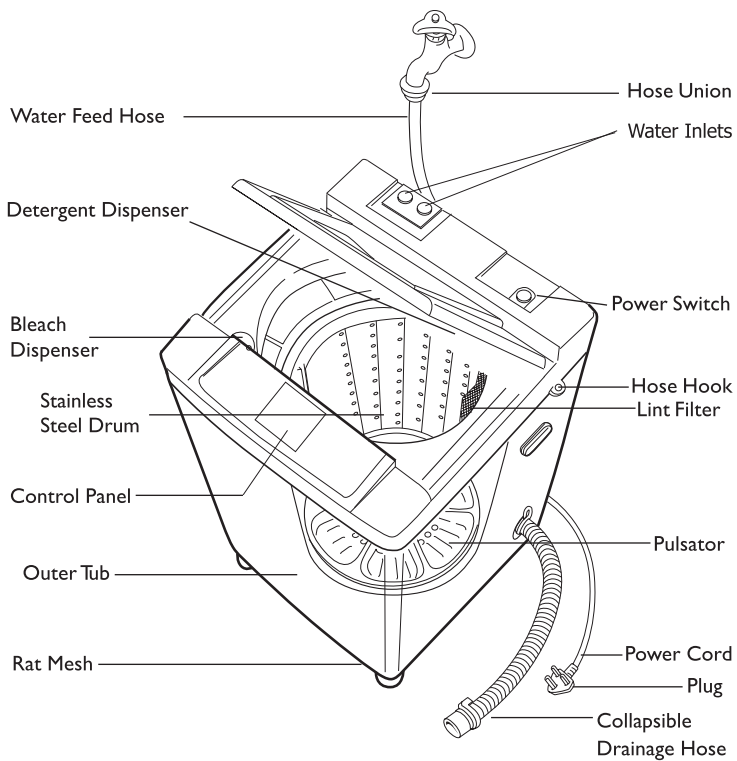



## Specifications

Model	GWF 650 FH	GWF 650 FC
Capacity	6.5 kg	
Temperature Options	Hot And Cold	Cold
Power Source	200-240 V, 50Hz, 5 A	
Power Consumption	425 W	
Water Consumption	Regular Cycle: 150 L at Max water level	
Water Pressure	0.3 - 10 kg/ cm <sup>2</sup>	
Wash Tub	Outer	Poly Propylene
	Inner	Stainless Steel
Overall Dimensions	560 mm (w) x 555 mm (d) x 920 mm (h)	
Net weight	32 kg	

In view of Godrej Policy of continuous development, features/specifications may change without notice. Features/specifications may vary with products. For specific features, please refer to the catalog/website.

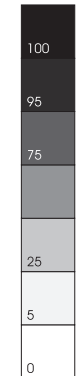





## Know Your Washing Machine

This washing machine has unique features to make your washing very convenient:

### Fuzzy Logic Controls

The intelligent micro-computer controls all operations precisely to ensure a perfect wash. The machine is equipped with fuzzy load and quality sensing to determine the water level and wash cycle appropriate for the wash load. Washing, rinsing and spin drying happens with a single selection on the control panel.

### Save Settings

One can define and save his/ her own program using Save Settings function as Favourite Program. (Refer pg no. 13 to learn how to use this function)

### Child Lock

This feature allows machine keys to be locked during operation. This prevents unintended changes during a wash cycle.

### Bleach Inlet

The bleach is dispensed between the outer and inner tub. Refer to page 23 for details.

### Imbalance Load Corrector

The Godrej Eon washing machine automatically corrects a load imbalance that might occur during the Dry Cycle. This protects the machine from damages.

### Rat Mesh

The rat mesh is provided to protect your machine from rodents. The cabinet of this Godrej Eon Washing Machine is made from prime quality powder coated galvanised steel to ensure a long life.

100	95	75	25	5	0
-----	----	----	----	---	---



## How To Install

### Choosing the right location

Install your Godrej Eon washing machine in an even, stable place. An unstable location

- Can create noise as your machine may vibrate
- Can be dangerous since vibrations may cause the machine to move

Keep a distance of at least 5 cm between the sides and rear of your machine to the nearest wall. This will prevent noise caused by the vibrations in your machine.

Do not place your machine in an area with high humidity or direct exposure to sunlight or rain.

This can

- Result in damaged insulation
- Cause deformation or discoloration of plastic parts

### Step-by-step installation

The front two legs can be adjusted so that the machine is on level with the ground.

- After loosening the adjusting nut, adjust the leg to the correct height by turning it. Then tighten the adjusting nut securely. Adjust the lock nut for adjusting the height.
- If the leg height is difficult to adjust because of an extremely uneven floor, place a board underneath and bring it to a level position.
- To check whether your machine is in level, use a weight attached to a string. The distance between the string and your machine should be the same from top to bottom.

### Ensuring proper earthing

**Your washing machine has a three-core 5A flexible cord. Make sure that electrical connections and earthing are done properly to avoid electrical shocks.**

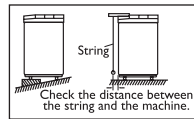
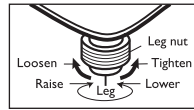
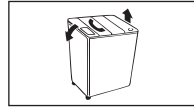
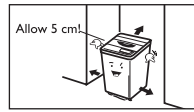
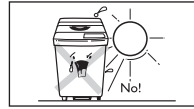

100
95
75
25
5
0





## How To Install

### Installing the drainage hose

- Insert the drainage hose in as far as it will go, then secure it tightly with the hose clamp. An improperly secured hose may leak.
- While attaching the drainage hose to a wash pan, leave a gap between the end of the hose and the adjacent surface. If the flat end of the hose comes in contact with a flat surface, drainage will be affected.

**Caution:** If the drainage hose is not installed properly, your washing machine may not function well, and the overflow prevention mechanism may cause your machine to stop in mid-cycle.

- While inserting the drainage hose into a wash pan or drain pipe, move the hook for easier installation.
- Move the hook back to its initial position before placing it in the slot provided on the side of your machine.

### Collapsible drainage hose extension.

- This hose is specifically designed for the Automatic range of washing machines from Godrej. This special hose can be stretched to increase its length. The length can be extended up to 2 mts. long. This feature is provided for consumer convenience, whereby he/ she can stretch the hose up to the drainage point, should it be far away from the machine. After completion of operation, the hose can be collapsed back to the original size and can be hooked on to the machine in an upright position.

**Caution:** Make sure the drainage hose is not too high otherwise it may not drain properly and may cause noise.

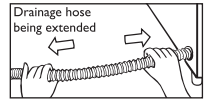
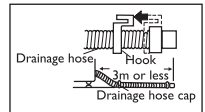
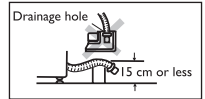
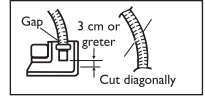
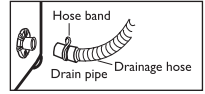



## How To Install

### Moving the drainage hose

The drainage hose can be installed on either the right or the left side. The connector port found on the right side of your machine can be moved without disconnecting the internal hose from the drainage valve.

- Remove the back cover, then grip the stopper securing the internal hose with your fingers and pull it to detach it from the outer shell.
- Turn the nut for the drainage hose connector port anti-clockwise.
- To detach, pull the internal hose from inside the washing machine.
- Remove the hose hole cap on the left-hand side, from inside the washing machine. Align the internal hose with the notch in the connector port and fit into place. Then put the nut in place and turn clockwise to secure from the outside.
- Insert the stopper into the securing hole on the left side of the outer shell and press down to secure the internal hose.

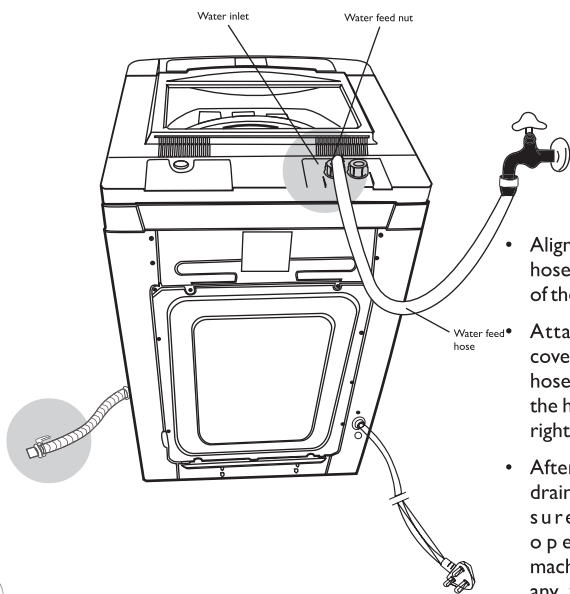
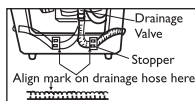
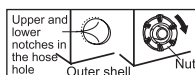
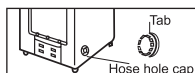
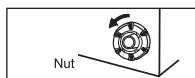

- Align the drainage hose with the edge of the stopper.
- Attach the back cover and fit the hose hole cap over the hose hole on the right-hand side.
- After moving the drainage hose, make sure you test-operate your machine. Check for any water leaks or unusual noises.



## How To Install

### Attaching the water feed hose to the tap

- The hose to be used for Hot water has the Red hose nut at both ends and the one to be used for Cold water has Blue hose nut at both ends.
- Pull the sleeve down with your fingers as you lower the entire hose to disconnect the union.
- Loosen the four screws on the hose union and then fit the union exactly over the mouth of the tap.
- Tighten the four screws evenly around the tap.
- Remove the seal from the union and turn the nozzle to tighten securely. (If the tap is large, square or oddly shaped, remove the inside ring to facilitate attachment).
- Grip the ring with your hand and pull it down, and then insert the nozzle. Separate the sleeve until you hear a click, and then push it back.
- After installation, check to ensure that the union does not come off while pulling down. Next, confirm that the union is properly installed by turning the water on and checking for leakage. If you see any leakage, adjust the section where there is a leakage.

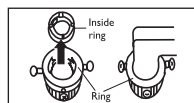
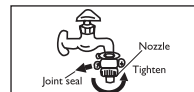
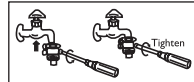
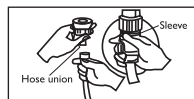

### Caution:

- Do not use a tap with a diagonal mouth or a movable tap since this may leak.

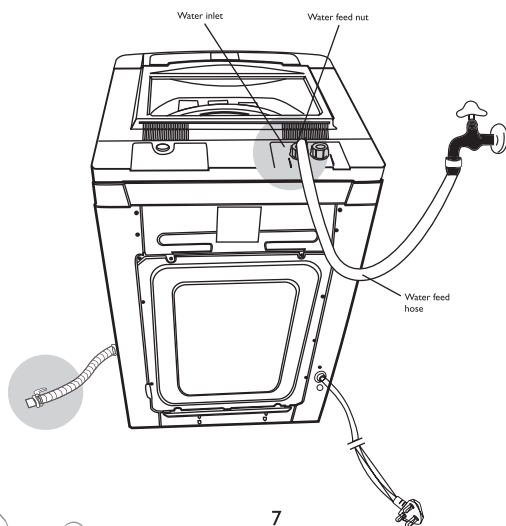



## How To Install

### Connecting the water feed hose to your washing machine.

- The hose to be used for Hot water has the Red hose nut at both ends and the one to be used for Cold water has Blue hose nut at both ends.
- Turn the water feed nut clockwise and tighten it on the end of the water feed hose securing it to the water intake valve.
- Tighten further by turning the water feed hose and water intake valve in the direction of the arrow as shown.
- Hold the water feed nut firmly. Turn the water feed hose back again only in the direction of the arrow as shown.
- Repeat steps 2 and 3 above, and tighten until you find it difficult to turn the water feed hose further.

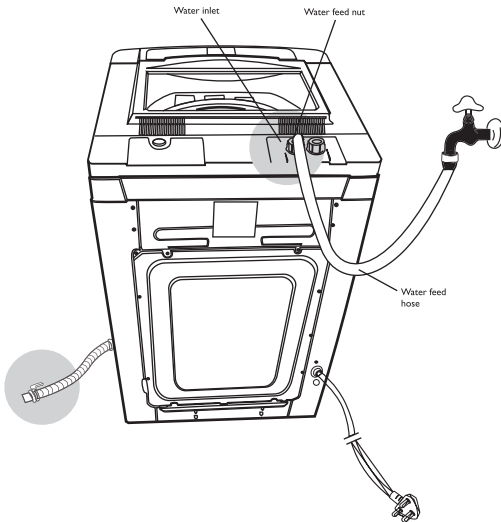
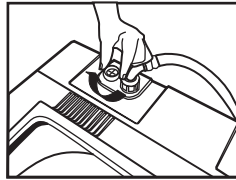
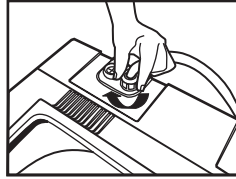

## Description: Control Panel

The control panel may become slightly warm due to the heat given off by the electronics and does not indicate a malfunction.

**Save Settings** - used to save user's Favourite Program.

**Water Level** - used to set water level manually. By default, no selection.

**Active Soak** - used to select and deselect Active Soak of 30 min.

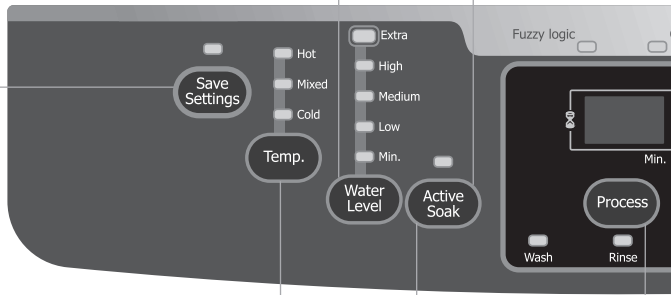

**Temp.** - used to select water inlet option. Default selection is cold. This feature is not available in GWF 650FC model.

**Child Lock Mode** - When Active Soak & Process buttons are pressed simultaneously during running of the machine, the machine goes into Child Lock Mode. In this mode, Child Lock LED will glow and no keys are accepted in this mode. To come out of Child Lock Mode, press Active Soak & Process keys simultaneously during the running of the machine and Child Lock LED will go off. If the machine is in Hold mode, the machine will not go in Child Lock Mode.

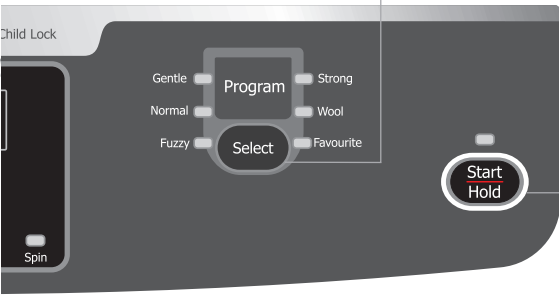

Select (Program) Button - used to select Program. By default, Fuzzy is selected.

Process - used to select combinations of Wash, Rinse & Spin.

Start/Hold - Starts washing machine operation when pressed. Pressing this button a second time will cause the machine to pause.







## Operation Of The Functions

### 1. Temp.Button - \*(Optional)

Press this button to select water inlet option.

The selection can be done as follows:

1. By default "Cold" is selected.
2. Press "Temp. Button" once to select "Mixed" option.
3. Press "Temp. Button" twice to select "Hot" option.

\*This feature is not available in GWF 650 FC model.

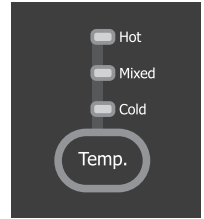

### 2. Water Level Button -

Press this button to select "Water Levels" manually

The selection can be done as follows:

1. By default, no water level will be selected.
2. Press this button once to manually select "High" water level.
3. Press this button twice to manually select "Min" water level.
4. Press this button thrice to manually select "Low" water level.
5. Press this button four times to manually select "Medium" water level.
6. To select "Extra" water as per your needs, keep this button pressed for more than 2 seconds to manually add more water than selected water level. Release the button to stop the extra water inflow.

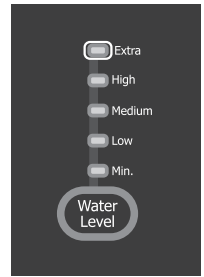

### 3. Active Soak Button -

Press this button to select or to deselect 30 min "Active Soak" time manually.

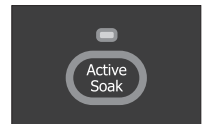



## Operation Of The Functions

### 4. Process Button -

Press this button to select combinations of Wash, Rinse & Spin processes.

Default Selection	Wash	Rinse	Spin
First press	Wash	-	-
Second press	Wash	Rinse	-
Third press	-	Rinse	-
Fourth press	-	Rinse	Spin
Fifth press	-	-	Spin

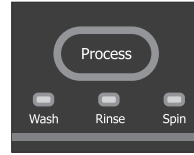

### 5. Program Select Button -

Press this button to select the Program.

With each press, one can select the Program.

Fuzzy → Normal → Gentle → Strong → Wool  
→ Favourite

The remaining time for the Program is displayed on seven segment display in minutes.

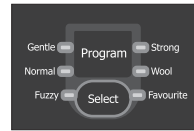

### 6. Start/Hold Button -

Press this button either to start the selected process or to pause the process.

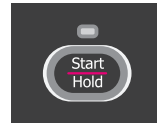

100

95

75

25

5

0



## Operation Of The Functions

### 7. Save Settings Button -

One can define & save his/her own program using Save Settings function as Favourite Program.

Before starting any cycle using Start Button, press Save Settings Button once. Machine will learn the selected cycle as it progresses. After completion of cycle, next time after power is turned on, Save Settings LED starts blinking indicating learning of past cycle is complete. If user wishes to set past cycle as his/her Favourite Cycle, he/she has to press Save Settings Button once. The user's favorite selections will get saved at Favourite Program location.

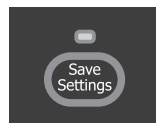

### 8. Child Lock -

Press Active Soak & Process Buttons simultaneously to activate Child Lock. All the keys on control panel will get locked until these two are pressed again simultaneously. Child lock LED will glow on Child Lock activation. To deactivate Child Lock, press the same keys again simultaneously.

### 9. Memory Backup -

During program operation if power supply goes off and comes back, on restoration of power supply machine will resume the remaining process from where it had stopped due to power failure.



## The Washing Process

	Select Cycle	Operation	Process
1	Wash only	<ol style="list-style-type: none"> <li>1. Press the Power button of the machine.</li> <li>2. Press Select button to choose suitable program. (ExceptWool &amp; Favourite program)</li> <li>3. Press Process button once to deselect Rinse &amp; Spin.</li> <li>4. Press Active Soak button to deselectActive Soak if already selected.</li> <li>5. Press Start button to startWash only.</li> </ol>	Begins with water intake - <b>Wash</b>
2	Wash - Rinse	<ol style="list-style-type: none"> <li>1. Press the Power button of the machine.</li> <li>2. Press Select button to choose suitable Program. (ExceptWool &amp; Favourite Program)</li> <li>3. Press Process button twice to deselect Spin.</li> <li>4. Press Active Soak button to deselectActive Soak if already selected.</li> <li>5. Press Start button to startWash + Rinse cycle.</li> </ol>	<b>Wash - Rinse</b> - Stops without draining
3	Rinse only	<ol style="list-style-type: none"> <li>1. Press the Power button of the machine.</li> <li>2. Press Select button to choose suitable Program. (ExceptWool &amp; Favourite Program)</li> <li>3. Press Process button 3 times to deselect Wash &amp; Spin.</li> <li>4. Press Start button to start Rinse only.</li> </ol>	Begins with drain cycle & spin cycle - <b>Rinse</b> - Stops without draining.
4	Rinse - Spin	<ol style="list-style-type: none"> <li>1. Press the Power button of the machine.</li> <li>2. Press Select button to choose suitable Program. (ExceptWool &amp; Favourite Program)</li> <li>3. Press Process button 4 times to deselectWash.</li> <li>4. Press Start button to start Rinse + Spin.</li> </ol>	Begins with drain cycle & spin cycle - <b>Rinse - Spin</b>
5	Spin only	<ol style="list-style-type: none"> <li>1. Press the Power button of the machine.</li> <li>2. Press Select button to choose suitable Program. (ExceptWool &amp; Favourite Program)</li> <li>3. Press Process button 5 times to deselect Wash &amp; Rinse.</li> <li>4. Press Start button to start Spin only.</li> </ol>	Begins with drain cycle - <b>Spin</b>
6	Soak - Wash	<ol style="list-style-type: none"> <li>1. Press the Power button of the machine.</li> <li>2. Press Select button to choose suitable Program. (ExceptWool &amp; Favourite Program)</li> <li>3. Press Process button once to deselect Rinse &amp; Spin.</li> <li>4. Press Active Soak button to select Active Soak if already not selected.</li> <li>5. Press Start button to start Soak + Wash.</li> </ol>	<b>Soak - Wash</b>
7	Soak - Wash - Rinse	<ol style="list-style-type: none"> <li>1. Press the Power button of the machine.</li> <li>2. Press Select button to choose suitable Program. (ExceptWool &amp; Favourite Program)</li> <li>3. Press Process button twice to deselect Spin.</li> <li>4. Press Active Soak button to select Active Soak if already not selected.</li> <li>5. Press Start button to start only Soak + Wash + Rinse.</li> </ol>	<b>Soak - Wash - Rinse</b> - Stops without draining

\* For Wool & Favourite Program, user can not change cycle operations.

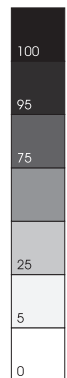

## Program Cycles

	Washing Method	Procedure For Setting Wash Cycle
1	Fuzzy Cycle	<ul style="list-style-type: none"> <li>* Turn POWER on (Fuzzy Cycle gets selected automatically)</li> <li>* Press Start/Hold to start the machine.</li> <li>* Water level and wash speed are automatically selected by the machine if not selected manually.</li> </ul>
2	Normal Cycle	<ul style="list-style-type: none"> <li>* Turn POWER on (Fuzzy Cycle gets selected automatically)</li> <li>* Press Select (Program) Button once to select Normal Cycle.</li> <li>* Press Start/Hold to start the machine.</li> <li>* Water level is automatically selected by the machine if not selected manually.</li> </ul>
3	Gentle Cycle	<ul style="list-style-type: none"> <li>* Turn POWER on (Fuzzy Cycle gets selected automatically)</li> <li>* Press Select (Program) Button twice to select Gentle Cycle.</li> <li>* Press Start/Hold to start the machine.</li> <li>* Water level is automatically selected by the machine if not selected manually.</li> </ul>
4	Strong Cycle	<ul style="list-style-type: none"> <li>* Turn POWER on (Fuzzy Cycle gets selected automatically)</li> <li>* Press Select (Program) button 3 times to select Strong Cycle.</li> <li>* Press Start/Hold to start the machine.</li> <li>* Water level is automatically selected by the machine if not selected manually.</li> </ul>
5	Wool Cycle	<ul style="list-style-type: none"> <li>* Turn POWER on (Fuzzy Cycle gets selected automatically)</li> <li>* Press Select (Program) Button 4 times to select Wool Cycle.</li> <li>* Press Start/Hold to start the machine.</li> <li>* By default High Water Level is selected.</li> </ul>
6	Favourite Cycle	<ul style="list-style-type: none"> <li>* Turn POWER on (Fuzzy Cycle gets selected automatically)</li> <li>* Press Select (Program) Button 5 times to select Favourite Cycle.</li> <li>* Press Start/Hold to start the machine.</li> <li>* Water level is automatically selected by the machine if not selected manually.</li> </ul>



Process					Approx. Time
Active Soak	Wash	Rinse 1	Rinse 2	Spin	
Default 30 min	12 min	2 min	2 min	6 min	85 min
Default 30 min	10 min	2 min	2 min	3 min	80 min
-	5 min	2 min	2 min	3 min	45 min
Default 30 min	12 min	2 min	2 min	3 min	82 min
-	3 min	1 min	2 min	1 min	41 min
Default 30 min	10 min	2 min	2 min	3 min	74 min

100

95

75

25

5

0



## Type Of Clothes That Can Be Washed In Various Wash Programs

Program	Recommended type of clothing that can be washed
Fuzzy	Any type of clothing
Normal	Shirts, skirt, pyjama, petticoat, nightgown, pant, etc
Gentle	Vest, undergarment, blouse, handkerchief, sock, silk garments, etc
Strong	Double bed sheet, khaadi fabric, etc
Wool	All wool garments which are recommended for machine wash by the garment manufacturer



## How To Select Water Level And Load Size

### Select the correct water level

Selecting the correct level will allow clothes to move freely in water and help you achieve the best washing results.

How to use WATER LEVEL		
Water Level Setting	Weight of clothes	Example of load
HIGH	3.1 - 6.5 kg	3 Trousers, 3 Shirts, 2 Skirts, 2 Night gowns, 2 Towels, 2 Vests, 1 Saree, 1 Dhoti and 1 Blouse
MEDIUM	1.51 - 3 kg	1 Trouser, 1 Shirt, 1 Skirt, 1 Night gown, 1 Towel, 1 Vest, 1 Saree, 1 Dhoti and 1 Blouse
LOW	0.81 - 1.5 kg	1 Trouser, 1 Shirt, 1 Vest, 1 Nightgown, 2 Blouses and 1 Skirt
MIN.	0 - 0.8 kg	1 Trouser, 1 Shirt, 1 Vest, Undergarment

While deciding the water requirement for the wash load, check the weight of the clothes and volume occupied by them.





## How To Measure Wash Load

Here are some of the average weights of commonly used clothes, to help you estimate the weight of the load to be washed

Approximate weight of clothes			
Item of clothing	Weight (in gms.)	Item of clothing	Weight (in gms.)
Double bedsheet	1000	Single bedsheet	500
Bath towel	500	Table cloth	650
Trousers	400	Jeans	600
Shirt	300	Baggies	500
Saree	500	Petticoat	400
Skirt	250	Pyjamas	400
Dhoti	200	Skirt	250
Night gown	250	Lungi	225
Vest	50	Blouse	100
Undergarment	50		

While deciding the water requirement for the wash load, check the weight of the clothes and volume occupied by them.

100	95	75	25	5	0
-----	----	----	----	---	---



## How To Operate

### When washing using the FUZZY cycle

#### Preparation

- Ensure that the electrical plug is properly connected.
- Ensure that the water supply and drainage hoses are correctly installed.

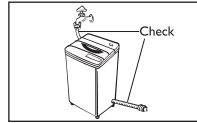

#### Put detergent and laundry in the basket.

#### Turn the power on

- Close the lid and turn the POWER switch ON.

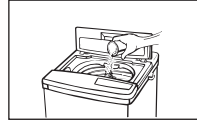

#### Start the cycle

- Press the START/HOLD pad to start the machine.
- The machine will run through a full cycle, including RINSE and SPIN.

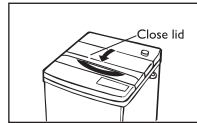

#### Cycle end

- A buzzer will signal the end of the cycle.
- Turn off the water tap.
- Machine will switch off after the completion of washing.



100
95
75
25
5
0





## How To Operate

### When washing woolens

100% wool garments, wool-polyester knit garments and other delicate fabrics like lingerie can be washed in your Godrej Eon washing machine.

### How to wash

- Set Cycle to NORMAL, set the water level at MIN., add detergent and run the WASH cycle for about a minute to dissolve the detergent.
- Insert the article to be washed, soak thoroughly, and close the lid.
- Press START/HOLD button and turn the POWER switch off to stop your machine.
- Set the cycle to WOOL, press MANUAL SELECT PAD 6 times. Press the START/HOLD pad to start.

### Caution:

- Articles be washed. Avoid washing articles made of animal fur, (e.g. cashmere, angora, mohair) or lace-knits etc.
- Articles to be washed should be fully soaked using the type of detergent specified on the garment label.
- Lukewarm water of 30°C is ideal for washing wool knit articles.
- The water level is automatically set at HIGH.





## Washing Tips

- Follow the instructions on the garment labels while washing laundry items. Avoid washing of all natural woollens and delicate knits such as lace knits.



- Turn garments inside out when washing to avoid piling and lint.

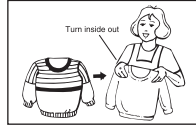

- Strings and fasteners of aprons and pillow cases should be fastened or tied.

### For hard-to-clean shirt collars and sleeves:

- Apply detergent to the soiled part of the garment and scrub by hand.

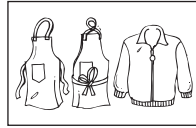

- If a garment is exceptionally soiled, soak it in liquid detergent for about 10 minutes before washing.





## How To Use Bleach

### When using bleach

Pour bleach into the bleach dispenser a little at a time. Be careful not to spill it.

Then run some water through the bleach inlet to rinse it. When using powdered bleach, dissolve it completely in water; then add it directly to the basket.

### Caution:

- Coloured and dyed fabrics may lose their colour if washed in bleach, so read the instructions on the label before washing.
- Do not apply bleach directly to laundry items.
- Do not allow bleach to spill on the control panel.

100	95	75	25	5	0
-----	----	----	----	---	---



## Safety Instructions

- Always use a proper power source.
- Do not use extension cords as these may not be properly earthed.
- Before connecting the power cord make sure to ground otherwise it may cause electric shock.
- Never use damaged electrical cords or plugs.
- This washing machine should be connected through a switch or a 5A MCB so that it can be disconnected from power supply.
- Use a secure tap connection to avoid leakage and wastage of water.
- Never place your hand in the basket while it is moving! Do not place your hand under the machine while it is operating. (Touching any of the machine's moving parts can be dangerous, even if it is moving slowly.)
- Do not press control panel pads with sharp objects. Using sharp objects to press the panel pads can result in electrical shocks or malfunctions.
- Do not pull the power cord with moist hands.
- Do not get the control panel wet. Getting the operation panel wet can result in shocks or malfunctions.
- Never wash or rinse articles of clothing treated with benzene, thinner, alcohol or other volatile or organic solvents. The presence of such chemicals can result in a fire.
- Do not use water with temperature over 55°C. Water that is too hot can cause malfunctions and deformation of the machine.\*
- If it takes 15 seconds or more for the machine to stop moving completely after the lid is opened (during the dry cycle with laundry in the basket), the brake is malfunctioning. You should have the machine repaired immediately.
- Do not use this product for business purpose.
- Young children should be supervised to ensure that they do not play with the appliance.
- Remove coins and pins from the pockets etc. as these may damage clothes or the machine.



\*This is applicable only for model GWF 650 FDC

100

95

75

25

5

0





## How To Maintain

### Water inlet

If the water fills into the basket too slowly...

Remove the water feed hose and clean the filter with a brush as shown alongside.

**Caution:** Do not remove the filter.

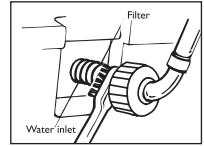

### Washing machine body

Before carrying out any maintenance on your washing machine, be sure to remove the electrical plug from its power source.

Clean the main body and control panel with a soft cloth. Hard-to-remove dirt can be cleaned by wiping with a soft cloth soaked in a mild detergent.

**Caution:** Do not clean the body or control panel with benzene, thinner, cleanser or other chemical cleaners. This can discolour or damage your machine's finish.

### The lint collector

Clean the lint collector after every use

- Remove the lint collector by pulling it out. If it is difficult to lift it out at the place where the machine has stopped, turn the basket by hand to a more convenient place and remove the lint collector.
- Remove the lint by turning the lint collector inside out.
- When the lint collector has been emptied and cleaned, push the net back in and replace the lint collector by inserting it in from above and pressing it down into place.

**Caution:** The net of the lint collector may sometimes be lifted up and may lie on top of the basket. Do not operate the washing machine with the net lying over the basket, as this may cause the net to rip or cause malfunction.

If the net is damaged, contact your nearest service centre.

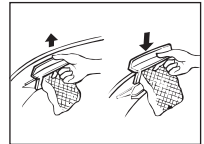

100	95	75	25	5	0
-----	----	----	----	---	---



## When Do You Call The Service Person...

Before you call the service person, please check the following:

### When your washing machine does not operate:

Check

- Has your machine's plug been inserted properly into the main power supply socket?
- Is the water tap turned on properly?
- Has the drainage hose been placed down to allow drainage?
- Is the power switch ON?
- Is the lid securely closed? (When beginning operation from the DRY cycle, your machine will not operate if the lid is open)
- Is the laundry load unbalanced? Is the warning light ON? If so, correct unbalanced load by manually rearranging the laundry evenly.

### When your washing machine leaks:

Check

- Is the hose coupling loose?
- Is the nozzle loose?
- Is the water feed hose connector clogged?
- Is the water inlet nut loose?

### When your washing machine makes an unusual noise:

Check

- Is your washing machine installed on an incline or uneven surface?
- Are there any match sticks, hairpins or metal objects being washed with the laundry?
- Has a foreign object got caught under the pulsator? Switch the power OFF and remove the centre screw, then lift the pulsator and look underneath.
- Is the load unbalanced, causing the basket to spin off-centre?

### When your washing machine does not drain:

Check

- Has the WASH-RINSE cycle been selected?
- Is the drainage hose bent?
- Has the drainage hose been placed down to allow proper drainage?
- Is the drainage hose properly connected to your machine?

### When your washing machine goes into E1 error mode:

Check

- Is there adequate water supply?
- Is the water supply tap open?

### When the washing cycle takes longer than usual:

Check

- Has the automatic load unbalance correction function (FILL - agitate for 1 min - DRAIN) been activated to correct a load unbalance?
- Is water supply available? Machine goes into hibernation mode and waits for water. This adds to the cycle time. End of wash is known through the Power Switch which moves up to OFF position.



100
95
75
25
5
0





## Don't Worry When...

- A small amount of water drains out of the drainage hose the first time you use your washing machine. This is merely the water left over from the performance inspection performed on your washing machine before it was shipped from the factory.
- Buzzing noises occur when the tub fills with water. They are caused by the operation of the water supply valve.
- The stop time of the WOOL cycle is long (4 seconds rest for 1 second operation). It does not indicate a malfunction.
- Sloshing sounds are made by your machine during the SPIN cycle. These are made by the water in the Liquid Balancing Ring which is meant to maintain balance of the Spin Tub and does not indicate a malfunction.
- When you restart your machine after opening the lid or pausing the machine during the SPIN cycle, there may be a small pause before the machine begins to spin as the drainage valve opens. Also, when you start your machine immediately after stopping it, there will be a short pause. This happens for safe operation.
- If you press the pads when the machine is operating or paused, the machine may return to the beginning of the cycle and lengthen operating time.
- Your machine automatically corrects a load unbalance that occurs during the SPIN cycle. If the unbalance is extremely bad, your machine will refill with water and agitate for a moment, and then the dry cycle will resume. This will happen twice. If the load becomes unbalanced a third time, a buzzer will sound 60 times.

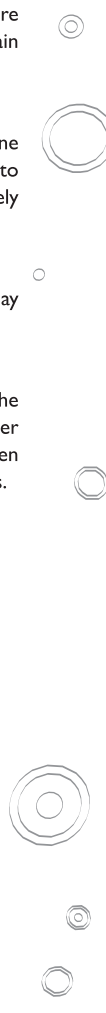



## Trouble Shooting

- **E1 error display**

If water does not come into the tub or rate of water inflow is very low, not enough to achieve the set water level, the machine beeps and displays "E1" error after 15 minutes of start of water intake. On opening and closing the lid, the machine will come out of error mode and will start water intake.

If the problem persists, please call service personnel.

- **E2 error display**

If water does not drain from machine, the display will show "E2" error along with beeps after 5 minutes of starting drain operation.

To correct the error, put the drain hose straight onto the ground or if it is clogged, please clean it.

On opening & closing the lid, machine will come out of error mode and will start draining again.

If the problem persists, please call service personnel.

- **E3 error display**

During spin operation if lid is open, machine will display "E3" error mode along with beeps. On closing the lid machine will come out of error mode and will start spinning. If the problem persists, please call service personnel.

- **E4 error display**

If there is a load unbalance, for two times, the machine will try to balance it out automatically. If machine goes into unbalance mode for the third time, "E4" error will be displayed on the control panel indicating manual balancing of load required. Balance the clothes evenly and close the lid to come out of error mode. If the problem persists, please call service personnel.



100

95

75

25

5

0





## Key Checklist

Almost every district in the country has a Godrej dealer - who has service representatives. Should you need any assistance, please get in touch with the nearest service provider and he will send a dependable mechanic to you. Your feedback, suggestions and ideas about washing machine care will help us serve you better.

Please check with the dealer as to who would be your service provider. For your convenience, please note down the details below.

Whom to contact in case you need assistance:

Name:

Phone:

Address:

Always quote the following when you require assistance of a Godrej Dealer or Branch.

Washing Machine Model:

Date purchased on:

Bill No.:

Machine Sr.No.:

Purchased from:





## Environment friendly suggestions

### Disposal of Packaging Material

After installing the washing machine, recycle/ reuse the corrugated box.

### Energy Conservation Tips for Washing Machine Use

You can help save limited natural resources like oil and coal by saving electricity.

Simply follow these guidelines.

1. Use the correct quantity of water depending on the quantity of clothes to be washed.
2. Use less foam making detergent for washing and use the correct quantity of detergent.
3. Use the correct cycle. This helps in saving electricity.
4. At the end of the cycle, please switch off the machine from the mains.



100

95

75

25

5

0



## Service Centres

Branch	Address	Telephone No.
Ahmedabad	4th Floor, APM Shopping Mall Near IOCL Petrol Pump, Shyamal-Karnavati 100 Ft. Road, Satellite, Ahmedabad 380 015.	
Bangalore	3rd Floor, The Karnataka Film Chamber of Commerce Bldg, 28, 1st Main, Crescent Road, High Grounds Nr. Shivanand Circle, Bangalore 560 001.	
Bhopal	217, Zone I, M.P. Nagar, Beh. Jyoti Talkies, Bhopal 462 011.	
Bhubaneswar	Highway Complex NH-5, Rudrapur, Bhubaneswar 752 101.	
Chandigarh / Mohali	Plot No.A-40, Phase-VIII-A, Industrial Area, Mohali-160059 (Punjab.)	
Chennai	No. 1, Sidco Industrial Estate, Ambattur, Chennai - 600 098	
Coimbatore	1st Floor, Gowtham Arcade T.V. Samy Road East R.S. Puram, Coimbatore 641 002.	
Delhi	Godrej Bhavan, 2nd Floor, Shershah Suri Marg, Okhla, New Delhi - 110 065.	
Faridabad	Godrej Bhavan, 2nd Floor, Shershah Suri Marg, Okhla, New Delhi - 110 065.	
Ghaziabad	Godrej Bhavan, 2nd Floor, Shershah Suri Marg, Okhla, New Delhi - 110 065.	
Goa Service Centre	Shed A-1, Corlim Industrial Estate Opp: Telephone Exchange Corlim, Goa 403 110	
Guwahati	Godrej Building, G.S.Road, Ulbarii, Flyover, Guwahati - 781 007.	
Hyderabad	201 & 202, Lala-1 Land Mark, 5-4-94 to 97, 2nd Floor, Above Digital Shoppo, Ranigunj, M.G. Road, Secunderabad 500 003	
Jaipur	502-506, 5th Floor, Gaurav Towers, Malviya Nagar, Jaipur 302 017.	
Kochi	Near Info Park Edachira, Thengode P.O. Kakkanad, Kochi 682 030.	
Kolkata	Block GN, Sector V, Salt lake, Kolkata - 700 091.	
Lucknow	C 3/3 & C3/4, Sanjay Complex Behind Akashwani Bhawan, Vidhan Sabha Marg Lucknow.	
Mumbai	Appliance Divn., Plant 4, Pirojshanagar, Vikhroli, Mumbai - 400079.	
Patna	Jeevan Deep Bldg, Exhibition Road Patna 800 001.	
Pune	Saraswati Sadan, 229/230, M.G. Road, Pune 411 001.	
Ranchi	C/o Surya Motors Pandra, Ranchi (Jharkhand).	

Call  
Centre : 6000 2030\* /  
1-860-3000 2030  
Toll-free : 1-800-225511

Website : [www.godrejsmartcare.com](http://www.godrejsmartcare.com) & [www.godrejappliances.com](http://www.godrejappliances.com)

E-mail : [smartcare@godrej.com](mailto:smartcare@godrej.com)

Please note - Toll Free number could be accessed only from MTNL / BSNL Landlines.

\*Please prefix your city STD code.

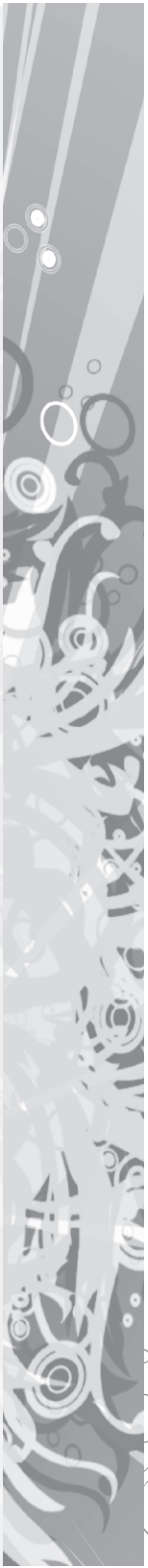



Congratulations!

You are now the proud owner of a new Godrej Eon washing machine.

You can look forward to years of  
smooth, trouble-free washing from your machine,  
as well as considerable savings in time, money and effort.

Please read this manual carefully as it will tell you  
how to operate your machine optimally in order to get the best results.

If you need any further clarifications, do contact your nearest  
Godrej dealer or any of our service centers/ offices.

We would be glad to help you.

We wish you an easier, more convenient life with your new  
Godrej Eon washing machine.





*Godrej*

**Godrej & Boyce Mfg. Co. Ltd.** - Appliance Division,  
Plant 11, Pirojshanagar, Vikhroli (W), Mumbai 400 079.

