

How to get the best out of your
Godrej Compact 7 Washing Machine...

Godrej



Contents

1. Description of parts & specifications
2. Features
3. How to install
4. How to wash
5. How to do intermediate spinning
6. How to rinse
7. How to spin
8. How to measure wash load & washing guide
9. Caution
10. How to maintain

User Manual

GWS 700PS 7 kg.
Semi automatic washing machine

I. Description of Parts & Specifications

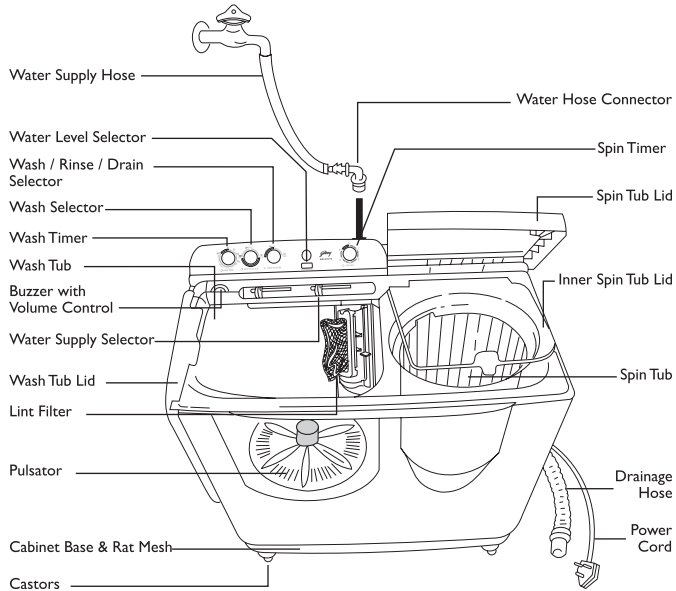

Specifications

Model	GWS 700PS	
Capacity	7 kg	
Type	Pulsator	
Input Wattage	Wash	380 W Max
	Spin	180 W Max
Revolution	Wash	210 rpm
	Spin	1250 rpm
Motor Type	Capacitor Type	
Water Consumption	High	64 litres
	Low	46 litres
Overall Dimensions	761 mm (w) x 447mm (d) x 935mm (h)	
Net Weight	24.8 Kgs	

In view of Godrej Policy of continuous development, specifications may change without notice.

2. Features

- 3 Wash Cycles** Choose between Gentle, Normal and Strong wash depending upon the kind of fabric you put in.
- Water Level Selector** Helps the machine select the level of water that suits the load of clothes being washed, ensuring a more effective wash and preventing wastage of water.
- 3 Rinse Options** This feature ensures effective removal of detergent with a continuous stream of water so that no suds or detergent deposits are left behind on the fabric. Thus the fabric and your skin are safe.
- Spin Shower facility** This facility in the Spin Drying tub ensures that all leftover detergent is removed effectively.
- Liquid Balancing Ring On Spin Tub** This ring distributes the wash load evenly in the tub so that the machine does not shake during the rotation of the spin tub.
- Separate Wash, Spin Timers** This feature gives you the convenience of washing and spin drying clothes simultaneously.

Active Soak

Your Godrej Washing Machine provides you the flexibility of soaking your bedsheets or heavily soiled clothes in the Wash tub itself to facilitate better detergent action.

To set the washing into soak mode, kindly follow the following steps: Put your Wash Load into the machine wash tub. Add desired amount of detergent. Fill Water to the set level. Select one of the three cycle cycles using the Wash Selector.

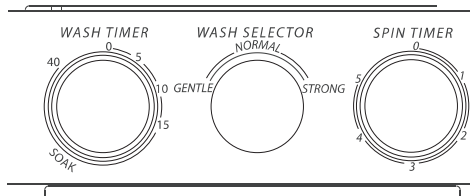

When you want to	Set wash timer knob to	Approximate Total time(min.)	Approximate Soak time(min.)	Approximate Wash time(min.)
Soak and wash heavily soiled clothes	Long soak, set by turning knob fully	40	25	15
Soak and wash not so heavily spoiled clothes	Midway of soak timer	30	15	15
Quick soak and full wash	Short position of soak timer	20	5	15

3. How to Install

Choosing the right location

Install your Godrej Washing Machine in an even, stable place. An unstable location:

- can be dangerous since vibrations may cause your machine to move.
- can create noise as your machine may vibrate.

Keep a distance of at least 5 cm between the sides and rear of your machine and the nearest wall. This will reduce noise while operating the machine.

Do not place your machine in an area with high humidity or direct exposure to sunlight or rain. This can:

- result in damaged insulation.
- cause deformation or discoloration of plastic parts.

The washing machine is provided with castors which gives you the flexibility to move the machine to a convenient location. After washing keep your washing machine at a location free from high humidity and direct sunlight.

Step-by-step installation

- Lower the drainage hose to the floor. Make sure that the drainage hose is not kept too high, else it may not drain properly.
- Connect the water supply pipe to the water inlet. Insert the hose connector onto the water inlet till you hear a click.
- Plug in the power cord into the power supply socket. The machine requires a 220V, 50 Hz 5 AC electrical supply.
- Place your machine on a level ground, if the floor is uneven, place a board underneath and bring it to a level position.
- To check if your machine is on a level ground, use a weight attached to a string. The distance between the string and your machine should be the same from top to bottom.

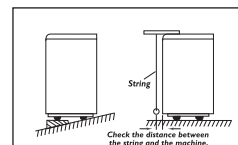
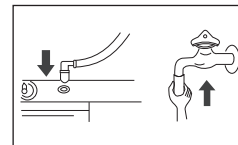
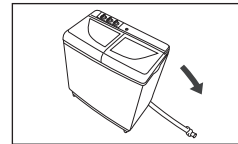
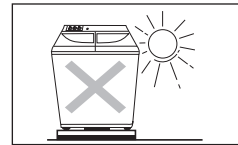
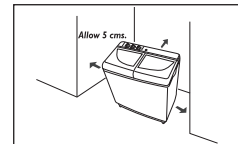
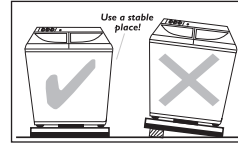

4. How to Wash

Precaution before washing

- Put your delicate clothes and undergarments in a washing net. This will prevent clothes from getting entangled during wash and protect your clothes. The washing nets are available in the market.
- Strings of aprons, petticoats, pyjamas etc. should be tied as this will prevent clothes from getting entangled.
- Close fasteners/zippers of trousers and jeans as this will prevent scratching of the wash tub.
- Remove articles like match sticks, hair pins etc. from pockets before washing.

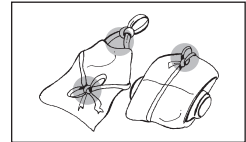
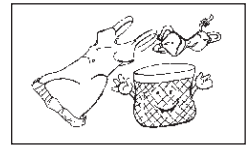

Washing

- Shift the selector knob to 'Wash/Rinse' position and the water supply knob to 'Wash Tub' position.
- Adjust the water level selector depending on the wash load. (Refer to page 8 on how to estimate the wash load and select water level.)

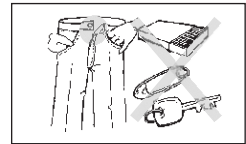

- Turn on the water supply and allow water to fill 2-3 cms lower than the water level selected. Add the detergent and mix properly, so that the detergent dissolves fully in water.

Note: If water flows out of the water feed indicator outlet, located in the Wash Tub it indicates that water is flowing at a high speed which could cause water to spill over into the Spin Tub. Reduce the water flow till water stops flowing out of the water feed indicator outlet as shown in the illustration.

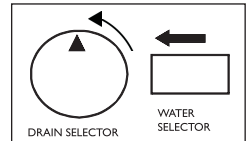

- Now put the wash load into the Wash Tub and fill water upto the water level selected.
- Select the cycle required for washing depending on the quantity of clothes to be washed, the type of fabric and the dirt levels of the clothes. Refer to page 8 for guidelines on selecting Wash Cycle.

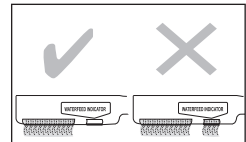

Choose between Gentle, Normal & Strong by turning the wash selector knob.

- Select the wash time required. The time will vary depending on the number of clothes and type of fabric. (Refer to page 8 for guidelines on setting wash time.)
- Set the wash time by turning the Wash Timer clockwise. The machine starts working immediately on turning the knob.
- A buzzer will indicate the completion of the wash cycle.
- After washing has stopped, shift the Selector knob to 'Drain' position to drain out the water from the Wash Tub.

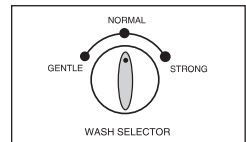

5. How to do Intermediate Spinning

After the wash cycle, it is suggested that an Intermediate spin cycle with the Spin Shower facility be carried out. This helps remove the detergent solution from clothes and rinsing becomes more effective.

How to use the Spin Shower

- Remove washed clothes from the Wash Tub and transfer them uniformly into the Spin Tub as shown in Fig A.
- The Spin Cap needs to be placed horizontally above the clothes as shown in Fig A. Even in case of a small lot of clothes, the Spin Cap should be placed above the clothes. This is a safety requirement.

The clothes and the Spin Cap should not be placed as shown in Fig B as this could lead to vibrations and cause a rattling sound during the Spin Cycle.

- Shift the Water Supply Selector knob to 'Spin Tub' and allow the water to flow for about 1 minute.
- Turn off the water supply, close the Inner Spin Tub lid and the Spin Tub lid.

Note: Spinning will not start till the Spin Tub lid is shut. For safety reasons, the machine is provided with a brake mechanism which gets activated as the spin tub lid is opened. This safe guards against accidental opening of the Spin Tub lid when the tub is spinning at a high speed.

- Set the Spin timer by turning the knob clockwise. Choose between 1-5 minutes depending upon type and no. of clothes. For details refer to page 7.

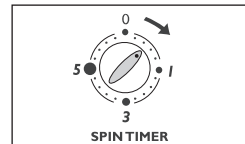
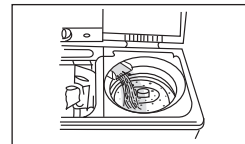
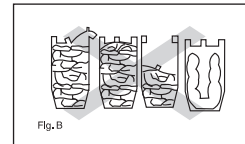
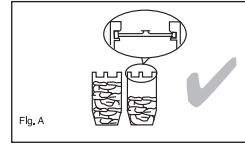

6. How to Rinse

After the wash and Intermediate Spin cycle, use the Rinse cycle. This helps remove detergent from the clothes and makes them soap-free. Rinsing can be done in two ways:

1. Overflow Rinse

In this mode, water is continuously supplied to the Wash Tub during rinsing and the dirty water flows out through the overflow hose. In this mode very efficient rinsing can be done since the concentration of detergent in the water is lowered significantly.

- Transfer the washed clothes from the Spin Tub into the Wash Tub after the intermediate Spin cycle.
- Shift the Water Selector knob to 'Wash/Rinse' position.
- Shift the water supply knob to 'Wash Tub' position.
- Adjust the water level. (For guidelines refer to page 8.)
- Start the flow of water, and set the Wash Timer between 6 - 8 minutes and rinse under continuous water flow.
- For best results repeat the process twice.

Caution

- Adjust the water flow while looking at the water level or water may spill out.
- Cover the Wash Tub with the Wash Tub lid while rinsing using "Overflow Rinse" option as this will prevent water spilling.

2. Rinsing with fixed amount of water

- Transfer the washed clothes from the Spin Tub into the Wash Tub after the Intermediate spin cycle.
- Shift the water selector knob to 'Wash/Rinse' position.
- Adjust the water level to 'High' and fill water up to the level.
- Set the wash timer to 2 - 3 minutes.
- After the rinsing cycle is over, shift the Water Selector knob to 'Drain' position. This will drain out the water from the Wash Tub.
- Transfer the clothes to the Spin Tub for intermediate spinning.
- Repeat this process two to three times for best results.

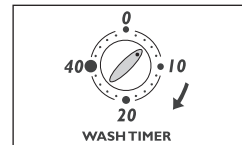
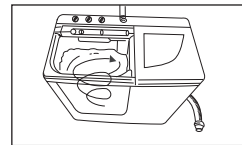
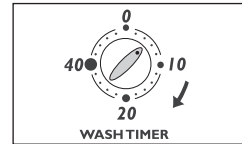
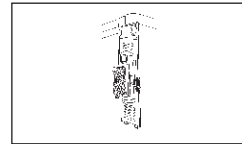
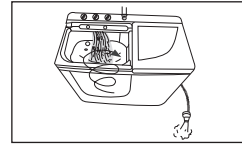

7. How to Spin

- Remove washed clothes from the Wash Tub and transfer clothes uniformly into the Spin Tub as shown in Fig A.

The Spin Cap needs to be placed horizontally above the clothes as shown in Fig A. Even in case of a small lot of clothes, the Spin Cap should be placed above the clothes. This is a safety requirement.

The clothes and the Spin Cap should not be placed as shown in Fig B as this could lead to vibrations and cause a rattling sound during the Spin cycle.

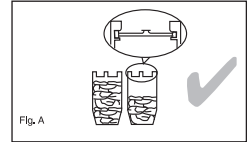

- Shut the Inner Spin Tub lid and the Spin Tub lid.

Note: The Spinning will not start till the Spin Tub lid is shut. For safety reasons, the machine is provided with a brake mechanism which gets activated as the Spin Tub lid is opened. This safe guards against accidental opening of the Spin Tub lid when the tub is spinning at a high speed.

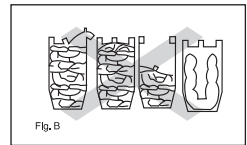

- Set the Spin time by turning the Spin Timer clockwise. Refer to table on guidelines for setting Spin time.
- Once the set spin time is over, the timer returns to its original position and the spinning activity stops.

Ending the process

- Switch off the main power supply and unplug the power cord.
- Drain the water completely from the drain pipe. Then hang the drainage hose on the hook provided on the side of the machine.
- Shift the water selector knob to 'Wash/Rinse' position.

Type of Fabric	Spin Time
Synthetic clothes	1 minute
Woolens	1-2 minutes
Shirts/ Trousers	2-3 minutes
Bedsheets/ Towels	5 minutes

Caution

- If bleaching powder or starch is used for washing, rinse the Wash Tub and Spin Tub with water and drain. This is required to remove any left over bleach/starch which may otherwise damage the Wash/Spin Tub.
- Remove the water supply joint first and then remove the water supply hose as this prevents water from spilling on to the controls of the machine.

8. How to Measure Wash Load and Washing Guide

Here are some of the average weights of commonly used clothes, to help you estimate the weight of the load to be washed.

Approximate dry weight of clothes			
Item of clothing	Weight	Item of clothing	Weight
Double bedsheet	1000	Single bedsheet	500
Bath towel	500	Table cloth	650
Trousers	400	Jeans	600
Shirt	300	Baggies	500
Saree	500	Petticoat	400
Pyjamas	400	Dhoti	200
Skirt	250	Nightgown	250
Lungi	225	Banian	50
Blouse	100	Undergarment	50

How to select wash cycle settings, wash time and water level.

Washing (Weight)	Water Level	Cycle Setting	Fabric Material	Wash Time
Less than 1.6 Kgs	Low	Gentle	Synthetic, Woolen	5 mins
		Normal	Cotton Hand Spun	7 mins
1.6 - 3.5 Kgs	Medium	Normal	Spoiled cotton, Hand Spun, School Uniforms etc.	10 mins
			Synthetic Clothes	10 mins
3.5 - 7 Kgs	High	Strong	Cotton, Linen	7-10 mins
			Soiled cotton, Bed sheets, Pillow covers, Towels, School Uniforms	10-15 mins

9. Caution

- Never put organic chemicals like benzene, alcohol or thinner, or even clothes stained with such material in the washing machine as this may lead to fire hazards.
- Never put your hands in the Spin Tub while it is moving.
- The washing machine should be plugged into a separate power socket. Do not take power supply for other appliances from the same source.
- Do not get the control panel wet as this may lead to an electric shock.
- If the Spin Lid is open and the rotations do not stop completely within 15 seconds, it indicates that the self acting brakes are malfunctioning. Get them repaired immediately by an authorised service personnel.
- Switch off the power supply immediately if the supply voltage drops abnormally. Low voltage power supply may result in overheating of the electrical parts of your machine.
- It is necessary to use the Spin Cap for the spinning operation. The cap holds the clothes in place during spinning and prevents them from flying off.
- Do not rub the control panel with chemicals like benzene, thinner, etc. This may deform the parts or the colour may fade.
- Do not keep lit match sticks, cigarettes or candles near the machine as the plastic parts in your machine may deform or catch fire.
- Do not pour hot water of temperatures above 50°C into the Wash or Spin Tub as this may result in deformation or damage to the plastic parts.

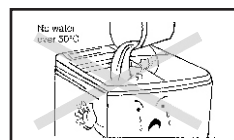
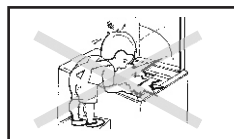
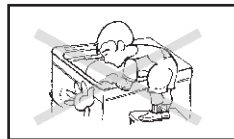

10. How to Maintain

Before you start cleaning your washing machine, take the electrical plug out of the main power supply socket.

How to clean the Wash Tub

- If the Wash Tub becomes dirty, clean it with a mild soap and soft brush. Do not use a scourer or a hard brush as this could scratch the Wash Tub.

How to clean Overflow Outlet

- Hold the top of the overflow strainer and pull it towards you.
- Remove the water hose from the water level adjustment knob.
- Clean the overflow filter from inside, under running water.
- After cleaning, insert the water hose into the water level adjustment knob.
- Insert the lower part of the overflow strainer in the groove of the Wash Tub.
- Push the upper part of the overflow strainer till you hear a click.

How to clean the Lint Filter

- Place your finger on top of the Lint Filter, press it and pull it towards you.
- Turn the filter inside out and clean under flowing water.
- To re-insert the Lint Filter, place the bottom part into the groove of the overflow strainer and push the upper part in place till you hear a click.

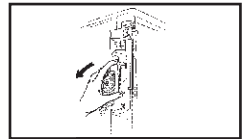
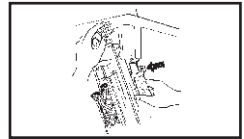
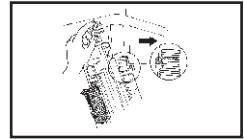

Service Centres

Branch/ Service Centre	Address	Telephone No.
Ahmedabad	1st Floor, M. Chandulal Estate, Near Alfa Hotel, Aslali-Jetalpur N.H. National Highway No.8, Aslali, Ahmedabad - 382 425.	Call Centre: 60002030 Toll Free: 1-800-225511
Bangalore	5th Floor, Chandra Kiran Building, 10A, Kasturba Road, Bangalore - 560 001.	Call Centre: 60002030 / 3989-8916 Toll Free: 1-800-225511
Bhopal	217, Zone I, M.P. Nagar, Behind Jyoti Talkies, Bhopal - 462 011.	60002030
Bhubaneshwar	181 - 183, Rasulgarh, Kalaraput, National Highway, Bhubaneshwar - 751 010.	60002030
Chandigarh / Mohali	Plot No. A-40, Phase-VIII-A, Industrial Area, Mohali -160 059 (Pb.)	60002030
Chennai	No.1, Sidco Industrial Estate, Ambattur, Chennai - 600 098.	Call Centre: 60002030 / 26521272 Toll Free: 1-800-225511
Coimbatore	1st Floor, Gowtham Arcade, T.V. Samy Road East, R.S. Puram, Coimbatore - 641 002.	60002030 / 0422 - 2545175 / 2545185
Delhi	Godrej Bhavan, 2nd Floor, Shershah Suri Marg, Okhla, New Delhi - 110 065.	Call Centre: 60002030 / 26935544 Toll Free: 1-800-225511
Faridabad	Godrej Bhavan, 2nd Floor, Shershah Suri Marg, Okhla, New Delhi - 110 065.	60002030 Toll Free: 1-800-225511
Ghaziabad	Godrej Bhavan, 2nd Floor, Shershah Suri Marg, Okhla, New Delhi - 110 065.	60002030 Toll Free: 1-800-225511
Goa Service Centre	Shed A-1, Corlim Industrial Estate Opp. Telephone Exchange, Corlim, Goa - 403 110.	60002030 / 2285670 / 2284787 / 324 / 386
Guwahati	Godrej Building, G.S. Road, Ulubarii, Flyover, Guwahati - 781 007.	2730530 / 539
Hyderabad	201 & 202, Lala-1 Land Mark, 5-4-94 to 97, 2nd Floor, Above Digital Shoppy, Ranigunj, M.G. Road, Secunderabad - 500 003.	Call Centre: 60002030 / 27537710 Toll Free: 1-800-225511
Jaipur	502-506, 5th Floor, Gaurav Towers, Malviya Nagar, Jaipur - 302 017.	60002030
Kochi	Near Info Park, Edachira, Thengode P.O., Kakkanad, Kochi - 682 030.	60002030
Kolkata	Block GN, Sector V, Salt Lake, Kolkata - 700 091.	Call Centre: 60002030 / 23576066 - 69 / 23576075-76 Toll Free: 1-800-225511
Lucknow	C 3/3 & C3/4, Sanjay Complex, Behind Akashwani Bhawan, Vidhan Sabha Marg, Lucknow.	Call Centre: 60002030 / 0512-2584911 / 3949108 Toll Free: 1-800-225511
Mumbai	Appliance Divn., Plant 4, Pirojshanagar, Vikhroli, Mumbai - 400 079.	Call Centre: 25302233 / 60002030 Toll Free: 1-800-225511
Patna	Jeevan Deep Bldg., Exhibition Road, Patna - 800 001.	60002030
Pune	Saraswati Sadan, 229/230, M.G. Road, Pune - 411 001.	60002030 Call Centre: 9522-25302233 Toll Free: 1-800-225511
Ranchi	C/o. Surya Motors, Pandra, Ranchi (Jharkhand).	60002030 / 2510738 / 2513230

Website: www.godrejsmartcare.com & www.godrejappliances.com E-mail: smartcare@godrej.com
Please note: Toll free number can be accessed only from MTNL / BSNL Lines.